

RaceHorseTrainer (RHT)

INTELLIGENT PERFORMANCE & DATA RECORDER for RACE- HORSES WITH FAST GPS and INERTIAL PLATFORM

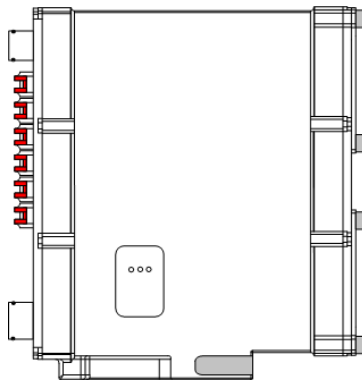

Introduction

The MAHTechS RHT (RaceHorseTrainer) with DGPS receiver and INERTIAL Sensors, is suitable for Your most sophisticated and high precision Racing Horses training and performance applications.

An internal Lithium battery is able to guarantee 5hours of continuous autonomous working. The battery can be easily recharged or quickly removed and changed.

It can be supplied with an optional user programmable display for the real time performances and sensors data.

The system can measure and record any time, distance and speed informations of a race horse in acceleration, roll-on and race performance without any additional device.

It can be connected to a wide series of optional sensors (for temperatures, pressures, step-counters, leg-bend, breath-flow,) to store all horse and human data in real time, together with performances data.

The instrument is available in the standard anodized aluminium case or in the ultra-light carbonium case.

Fully user programmable also for intermediate and lap timing.

Removable Compact Flash Card memory from 64Mbyte to 1Gbyte.

Supplied with a sophisticated PC software for setup and analysis and the GPS antenna.



Optional Wireless WiFi PC connection is available for remote setup and data download.

- N°12 High Accuracy 16bits Analogue Inputs
- N°8 Frequency Inputs
- N°6 Switch Inputs
- N°1 10 Mbit Ethernet Port
- N°2 ports for others devices connection (Data Logger, Displays, Telemetry Unit,)
- N°1 DGPS 14 Channels
- N°1 4 ports internal HUB
- N°1 Optional Display Connection
- N°3 High Accuracy $\pm 5g$ Accelerometers
- N°3 High Accuracy $\pm 150^\circ/\text{sec}$ Gyroscopes
- N°1 Optional Light Barrier Connections
- Autosport Fiber 6 poles connectors
- IP67 anodized alluminium case
- Size 214x54.5x205mm
- Weight of:
 - 2400gr. (anodized alluminium case)
 - 1200gr. (carbonium fiber case)

Connector Information

Connector 1 – SENSORS		AS216-35PN	
		Mating Connector AS616-35SN	
PIN	FUNCTION	PIN	FUNCTION
1	Analogue Input 1	28	Frequency Input 6
2	Analogue Input 2	29	5V Out#5
3	Analogue Input 3	30	Digital GND #6
4	Analogue Input 4	31	Digital GND #4
5	Analogue Input 5	32	VBATT Out#3
6	Analogue Input 6	33	VBATT Out#4
7	Analogue Input 7	34	Switch Input 2
8	Analogue Input 8	35	Switch Input 3
9	Analogue Input 9	36	Frequency Input 7
10	5V Out#1	37	Frequency Input 8
11	5V Out#2	38	Expansion Port Pin3
12	5V Out#3	39	Expansion Port Pin4
13	5V Out#4	40	Analog GND #5
14	Analogue Input 10	41	Analog GND #6
15	Analogue Input 11	42	Digital GND #1
16	Analogue Input 12	43	Analog GND #1
17	VBATT Out#1	44	Analog GND #2
18	NC	45	Analog GND #3
19	Frequency Input 2	46	Analog GND #4
20	Frequency Input 3	47	NC
21	Expansion Port Pin1	48	Digital GND #2
22	Expansion Port Pin2	49	5V Out#6
23	Switch Input 6	50	Digital GND #3
24	Switch Input 5	51	Digital GND #5
25	VBATT Out#2	52	Digital GND #7
26	Frequency Input 4	53	--VBATT Power IN
27	Frequency Input 5	54	+ VBATT Power IN
		55	NC

Connector PORT 2 – PC&SW – ASC105-06SN
Mating Connector ASC605-06PN

PIN	FUNCTION
1	Ethernet TX+
2	Ethernet TX-
3	Ethernet RX+
4	Ethernet RX-
5	Switch
6	Sw GND



Connector PORT 3 – CAN– ASC105-06SN

Mating Connector ASC605-06PN

PIN	FUNCTION
1	CAN1H
2	CAN1L
3	CAN2H
4	CAN2L
5	+ Battery Voltage Output (500mA max)
6	- Battery Voltage Output

Connector PORT 4 – POWER - ASC605-06PN

Mating Connector ASC105-06SN

PIN	FUNCTION
1	+ Battery Voltage Output (500mA max)
2	- Battery Voltage Output
3	NC
4	NC
5	+ Battery Voltage Input (2500mA max)
6	- Battery Voltage Input

Connector PORT 5 – SPEED&FREQ – ASC105-06SN

Mating Connector ASC605-06PN

PIN	FUNCTION
1	Analogue Speed Out
2	Analogue GND
3	PPM Speed Out
4	Digital GND
5	Freq. Input 1
6	VBATT Out#5

Connector PORT 6 – TRIGGERS – ASC105-06SN

Mating Connector ASC605-06PN

PIN	FUNCTION
1	Lap Trigger Input
2	Split Trigger Input
3	Digital GND
4	VBATT Out#5
5	Lap Trigger Pulse Out
6	Split Trigger Pulse Out

Connector PORT 7 – DISPLAY – AS210-35SN

Mating Connector AS610-35PN

PIN	FUNCTION
1	VBATT Out
2	Battery GND
3	CAN3 H
4	CAN3 L
5	EthTx+
6	Eth Tx-
7	Eth Rx+
8	Eth Rx-
9	Sw3
10	Sw4
11	NC
12	Sw GND
13	Sw GND

Ordering Information

DESCRIPTION	PART NUMBER
RACEHORSE-TRAINER	K 600 006 001 001

Specifications

DESCRIPTION	VALUE
Supply Voltage	8 to 32Volt DC
Supply Current	450mA@12Volt DC
Operating Temperature Range	- 20 to +70°C (-4 to +158°F)
Storage Temperature Range	- 40 to +85°C (-40 to +185°F)
Weight (alluminium)	2400 gr. (6.0ounces)
Weight (carbonium fiber)	1200 gr. (3.0ounces)
Environmental	IP67



Dimensions

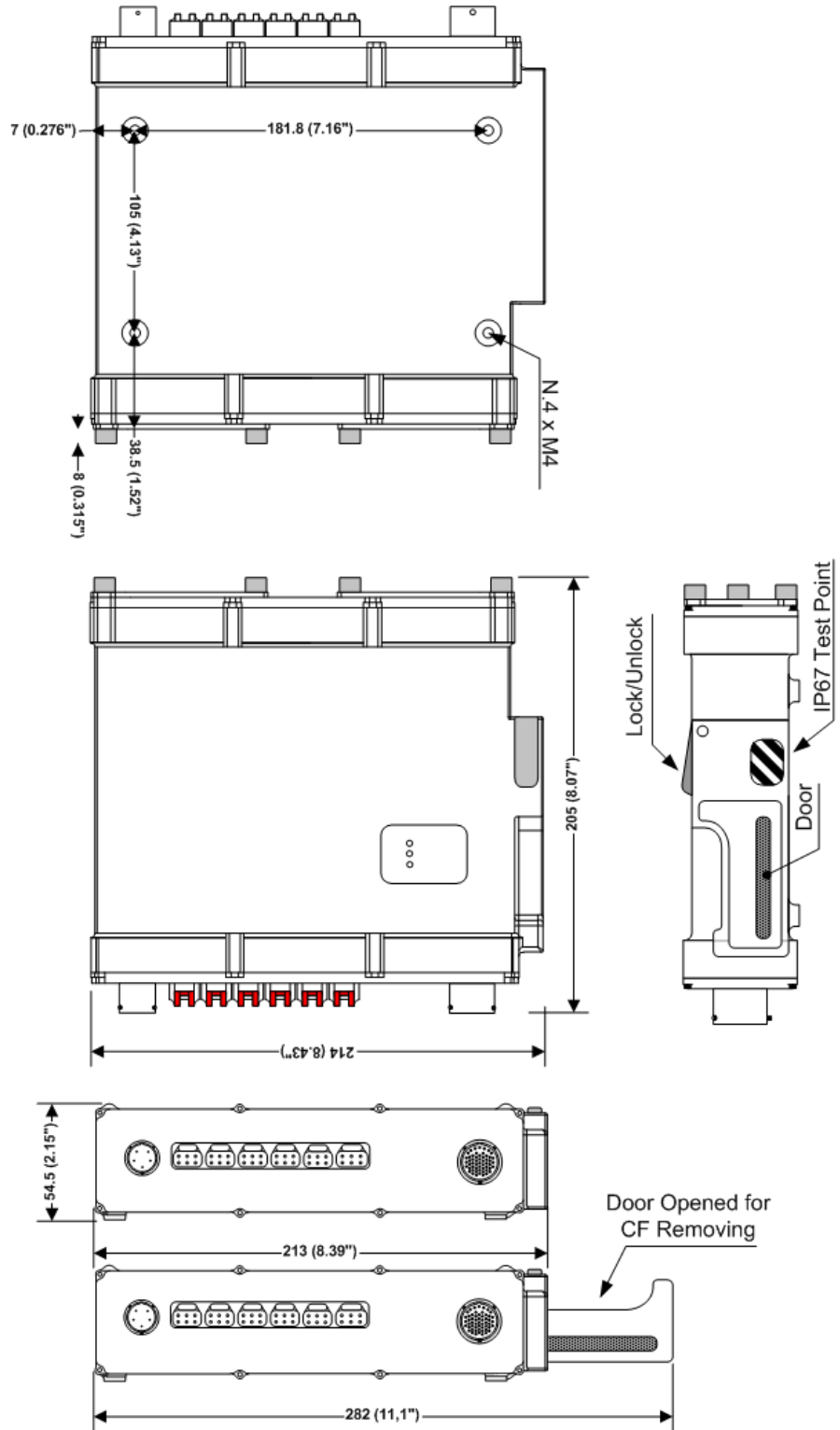

Dimensions in millimetres and (inches)

MAHTechS Contact

MAHTechS srl - Via Per Spilamberto, 4AB
 41051 Castelnuovo Rangone (Modena) – ITALY
 Telephone +39 059 533 2067 Telefax +39 059 533 2068
 E-mail info@mahtechs.com Web www.mahtechs.com